



HOSS Armament Platform

Ordnance Stores System for UH-1 Huey Series Aircraft





HOSS on UH-1

AT A GLANCE

- Provides six store stations
 - four full time fixed-forward
 - two changable pintle crew-served or fixed-forward
- Modular system
- Side-to-side interchangeable
- Quick release

CFD International has designed and manufactured **HOSS - Huey Ordnance Stores System** - a modern external armament system that adds up to four jettisonable fixed-forward store stations and two crew-served weapon pintles which can also be locked in the fixed-forward position. The HOSS uses a modular approach that allows for maximum firepower when needed, and weight savings when not. The system is low maintenance, damage tolerant and meets or exceeds MIL-STD-810G and MIL-STD-461F.

The baseline components of HOSS consist of both a forward and an aft arm, as well as a base plate. The forward and aft arms attach to the existing aircraft lugs via two quick-release pins and two-expansion pins without the need for any aircraft modifications. The base plate has an attachment point for a crew-served weapon pintle, locations for adapters to install an inboard vertical store station rack (Alkan rack shown - BRU optional), and the option for either a 45-degree tip station or vertical outboard store station. The latter two options attach to the base plate via precision-machined lugs and four quick-release pins. The HOSS components are interchangeable between left and right installations on the aircraft. Depression guards are attached to the HOSS for when a crew-served weapon is installed along with inboard or tip station stores.

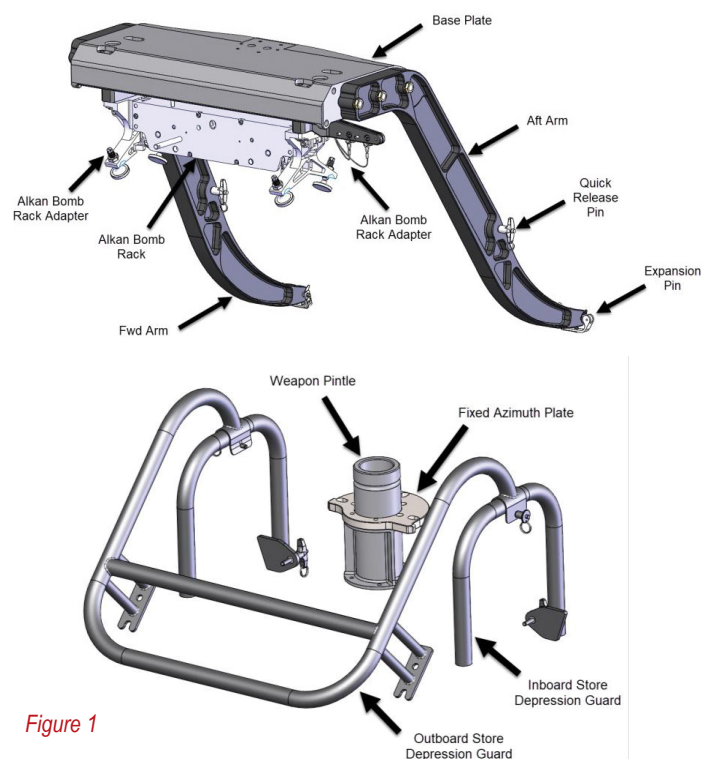
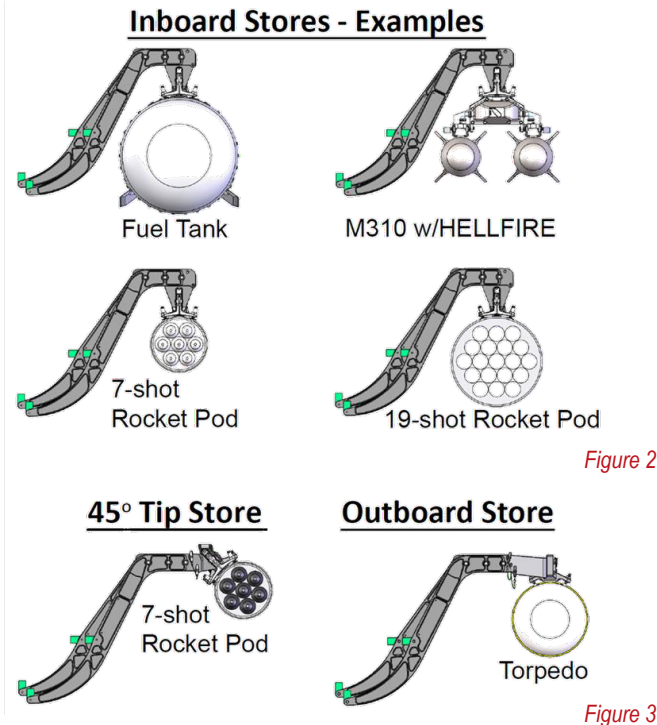

Figure 1

Store Stations

The inboard store station was designed with multiple weapons and stores in mind, ranging from large diameter fuel tanks and a M310/HELLFIRE launcher to 7 and 19 shot rocket pods as shown in Figure 2. Figure 3 shows the relative positions of the 45 degree tip store and outboard store.



Tip Stores

The 45-degree tip store was designed to accommodate a 7-shot rocket pod with both an inboard store and pintle-mounted weapon installed while minimizing the loss of depression angle of the gun. Figure 4 shows a GAU-21 pintle-mounted weapon with superimposed images of the fuel tank and M310/HELLFIRE on the inboard station and a 7-shot pod on the tip station.

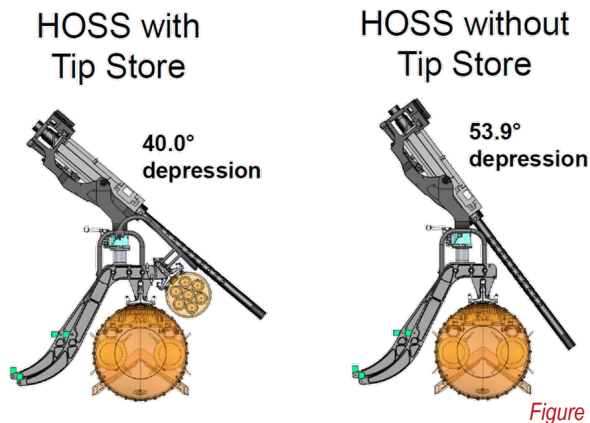

Outboard Adapters

Adapters for the outboard store station were specifically designed to ensure torpedo clearance on high-skid, float-equipped 412 aircraft (Figure 5). All adapters are compatible with Alkan and BRU racks. The outboard store station was not designed to allow for a simultaneous inboard store, but the pintle mount remains available for use.

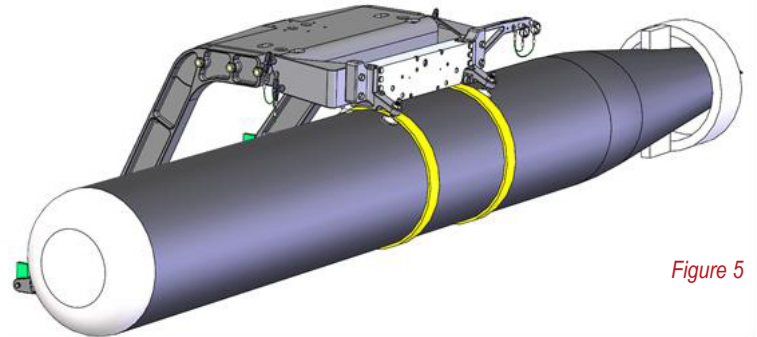

CFD International provides the U.S. Government and foreign military allies with precision-engineered weapon system solutions emphasizing accuracy, reliability, durability and light weight. Founded in 1985 by the late Paul Sanderson - inventor of the OMS - the company's focus is serving warfighters by providing premium weapon systems for helicopters. With over 35 years of experience, and holding more than 37 patents, CFD specializes in the design and manufacture of the finest weapons/sensor mounting solutions, ammunition handling and fire-control armament management systems available today. We are the world leader in providing a turn-key, integrated solution customized to your specific needs and requirements.

HOSS Armament Platform - Compatible Weapons

GUNS	ROCKETS/MISSILES	FUEL PODS
• M2/M3/M3D/M3M/M3P/GAU-18/GAU-21 (.50-cal machine gun)	• M260/LAU-68 (7-shot rocket pod)	• Robertson 75 Gallon (External auxiliary fuel pod)
• GAU-19 (.50-cal Gatling gun)	• M261/LAU-61 (19-shot rocket pod)	• Robertson 116 Gallon (External auxiliary fuel pod)
• M134/GAU-2 (7.62mm Gatling gun)	• DAGR (2.75-inch guided missile)	• Dudlik 77 Gallon (External auxiliary fuel pod)
• MK 19 (40mm grenade launcher)	• TALON (2.75-inch laser guided rocket)	
• NC-621 (20mm cannon)	• M310 (missile launcher, 2-rail) • AGM-114 HELLFIRE (guided missile)	
• M240 (7.62mm machine gun)	• Viper Strike (guided glide bomb)	
	• Griffin (laser guided bomb)	
	• AIM-92 Stinger (guided missile)	
	• AIM-9 Sidewinder (guided missile)	

NOTE: HOSS is compatible with all of the weapons and attachments listed. All weapons and combinations meet mil-spec jettison and ground clearance requirements per MIL-STD-1289.

For more information on HOSS and to discover other CFD products and services visit us on our website at www.cfdintl.com

Or see us on YouTube: www.youtube.com/user/CFDIntl